

Dynamo Sprint 04

DIM_03

10.10.2024



Learning from Bricks

Number of Bricks: 26

One Brick Project				
Count	Family	Type	Cost (\$uro)	Weight (g)
1	one brickGeneric	1R_1x1	0.00	0.00
4	one brickGeneric	1R_1x1	0.30	0.72
20	one brickGeneric	1R_1x2	1.20	7.20
1	one brickAngle	1R_1x2	0.15	0.56
2	one brickGeneric	1R_1x4	0.18	1.44
6	one brickGeneric	1R_2x2	0.60	4.32
12	one brickGeneric	1R_2x3	1.20	12.96
4	one brickGeneric	1R_4x6	1.20	8.64
2	one brickGeneric	2R_1x1	0.14	0.56
1	one brickGeneric	2R_1x2	0.00	1.91
52			5.47	36.10

Schedule

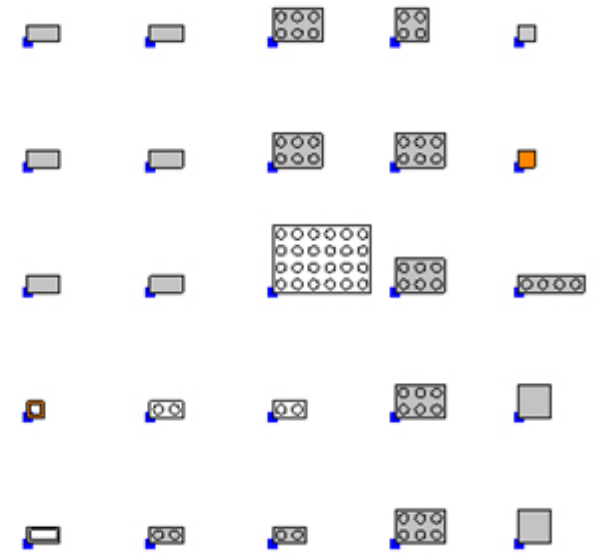

Roll-Out

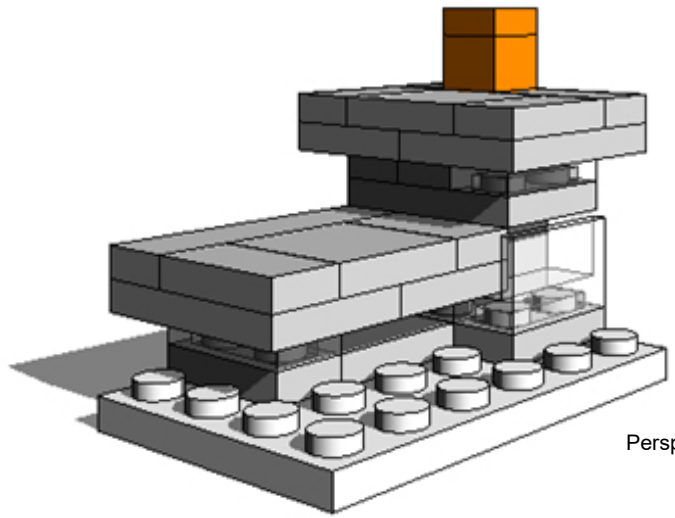

Perspective

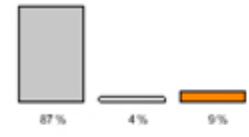

Bar Graph

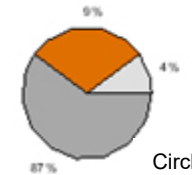

Circle Diagram

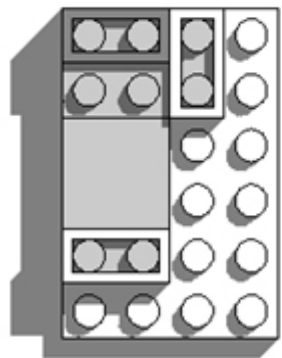

Main Floor

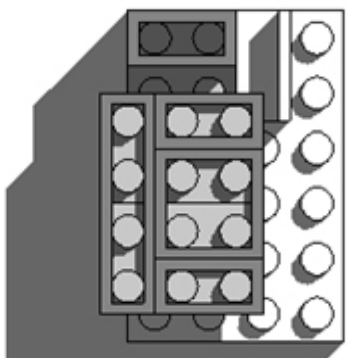

1st Floor

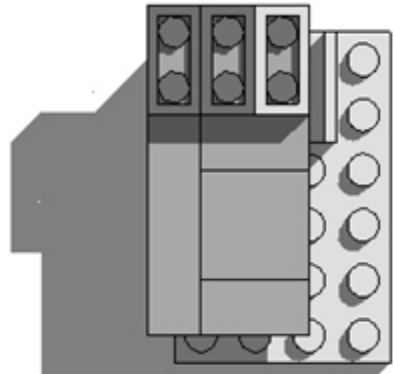

2nd Floor

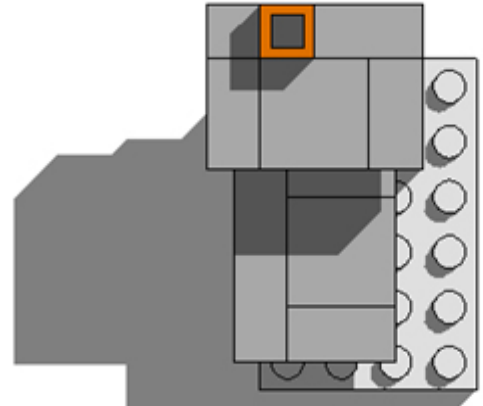

Roof

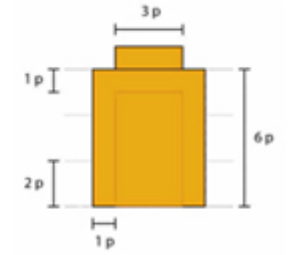

roll out #1

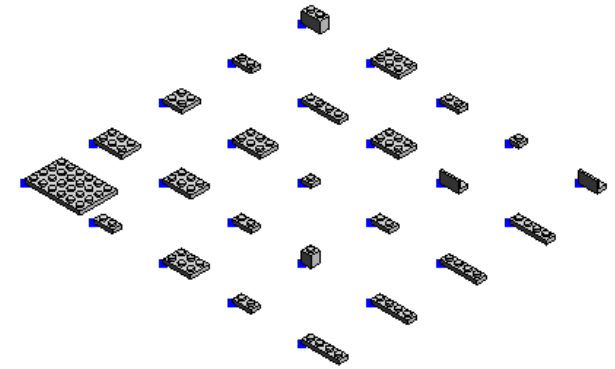

select model elements

Select Model Elements

Change	Elements
Elements: 442511 444642 444905	
445133 445274 445435 445493	
445553 445573 445993 446005	
446117 446134 446510 446592	
446616 485962 522348 526203	
554595	

Watch

Item	FamilyType
1	1H_4x6 442511
2	1H_2x3 444642
3	1H_2x2 444905
4	1H_1x2 445133
5	1H_1x2 445274
6	1H_1x2 445435
7	1H_2x3 445493
8	1H_2x3 445553
9	1H_1x4 445573
10	1H_2x3 445993
11	1H_2x3 446005
12	1H_1x2 446117

get the Types from the selected elements

FamilyInstance.FamilyType

_familyInstance	_familyType
	AUTO

place bricks in model on points

FamilyInstance.ByPointAndLevel

familyType	FamilyInstance
point	
level	

Levels

Level	Levels
L001	

make grid of points

Code Block

```
0..6000..1500;
```

Number: 3000.000

Number: 0.000

Point.ByCoordinates

x	y	z	Point
		xxx	

List.Flatten

list	var[]..[]

Watch

Item	Value
0	0
1	1500
2	3000
3	4500
4	6000

Take care about the lacing ;)

roll out #2

the

lyType
AUTO

place bricks in model on points

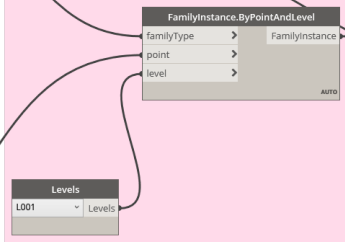

get elements from placed Instances



data check

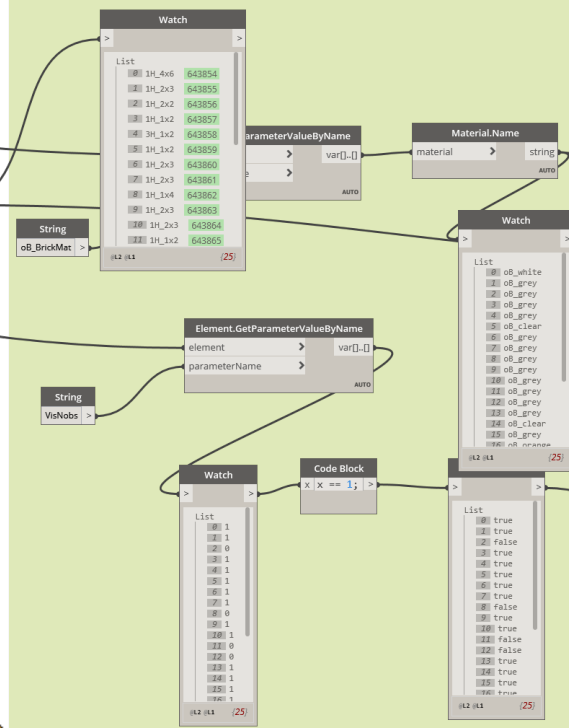

set material parameters in overview

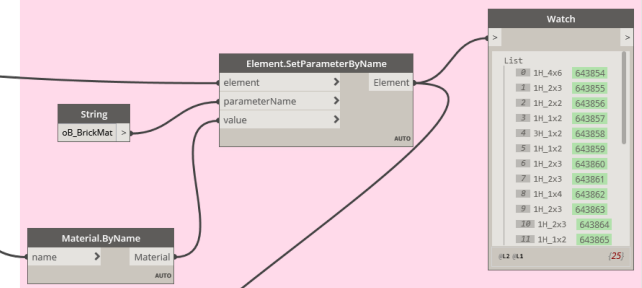

set 'nobs' in overview

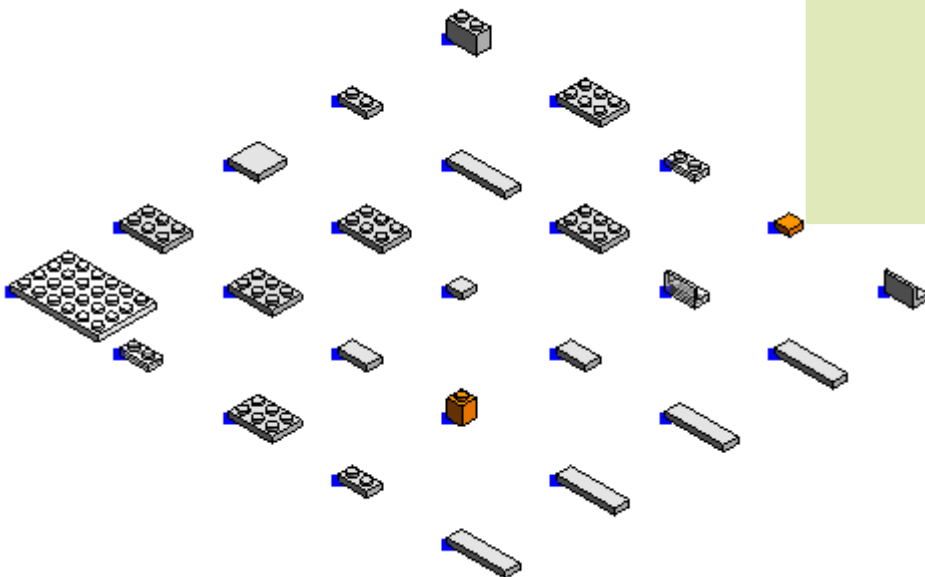
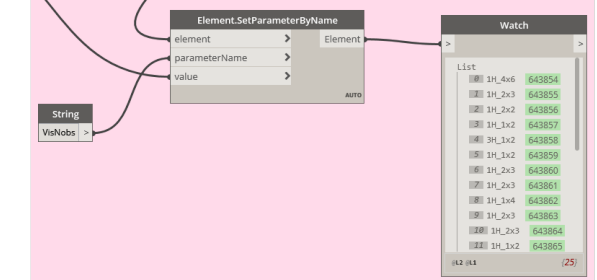

**Wat is het verschil?
tussen #1 and #2?**

...